



**SANKO**  
SANKO MFG., CO., LTD.

Power up Kansai 1999

# 追加スペシャルアダプター

## UL-90(1609)



※印及び SUS は受注生産

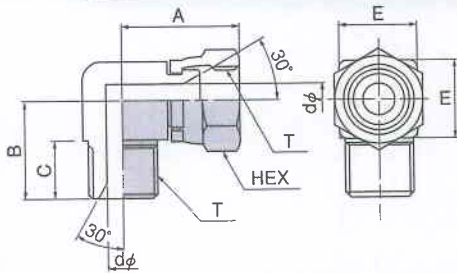

接続口金具：SR-05

呼び径	ねじ T	Amm	Bmm	Cmm	dφmm	Emm	HEXmm
6	G <sup>1</sup> / <sub>4</sub>	27.0	21.0	13	5.5	16	19
9	G <sup>3</sup> / <sub>8</sub>	32.0	25.0	15	7.0	20	22
12	G <sup>1</sup> / <sub>2</sub>	36.0	30.0	18	10.0	24	27
19	G <sup>3</sup> / <sub>4</sub>	43.0	35.0	20	16.0	30	36
25	G 1	49.0	40.0	22	21.5	36	41
32	G1 <sup>1</sup> / <sub>4</sub>	60.5	47.0	25	27.5	45	50
38	G1 <sup>1</sup> / <sub>2</sub>	62.0	50.0	25	33.0	50	60
50	G 2	75.5	61.5	30	44.0	63	70

## UL-90(1613)



※印及び SUS は受注生産

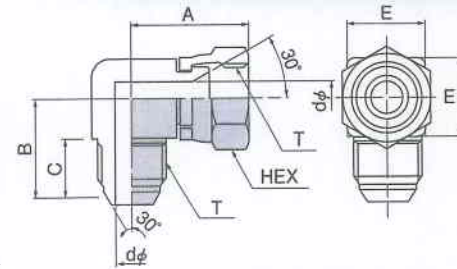

接続口金具：SR-04

YA1021

呼び径	ねじ T	Amm	Bmm	Cmm	dφmm	Emm	HEXmm
6	G <sup>1</sup> / <sub>4</sub>	27.0	24.0	16.0	5.5	16	19
9	G <sup>3</sup> / <sub>8</sub>	32.0	27.5	17.5	7.0	20	22
12	G <sup>1</sup> / <sub>2</sub>	36.0	32.0	20.0	10.0	24	27
19	G <sup>3</sup> / <sub>4</sub>	43.0	36.5	21.5	16.0	30	36
25	G 1	49.0	40.5	22.5	21.5	36	41
32	G1 <sup>1</sup> / <sub>4</sub>	60.5	49.5	27.0	27.5	45	50
38	G1 <sup>1</sup> / <sub>2</sub>	62.0	52.0	27.0	33.0	50	60
50	G 2	75.5	61.5	30.0	44.0	63	70

## UL-90(0609)



※印及び SUS は受注生産

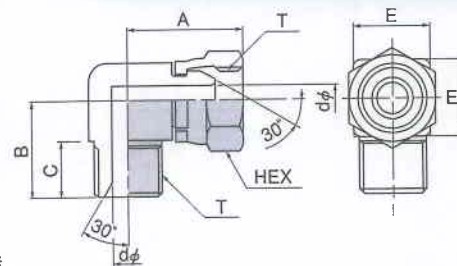

接続口金具：SR-02・SR-05

FUJI1059

呼び径	ねじ T	Amm	Bmm	Cmm	dφmm	Emm	HEXmm
6	G <sup>1</sup> / <sub>4</sub>	27.0	21.0	13	5.5	16	19
9	G <sup>3</sup> / <sub>8</sub>	32.0	25.0	15	7.0	20	22
12	G <sup>1</sup> / <sub>2</sub>	36.0	30.0	18	10.0	24	27
19	G <sup>3</sup> / <sub>4</sub>	43.0	35.0	20	16.0	30	36
25	G 1	49.0	40.0	22	21.5	36	41
32	G1 <sup>1</sup> / <sub>4</sub>	60.5	47.5	25	27.5	45	50
38	G1 <sup>1</sup> / <sub>2</sub>	62.0	50.0	25	33.0	50	60
50	G 2	75.5	61.5	30	44.0	63	70

## UL-90(0613)



※印及び SUS は受注生産

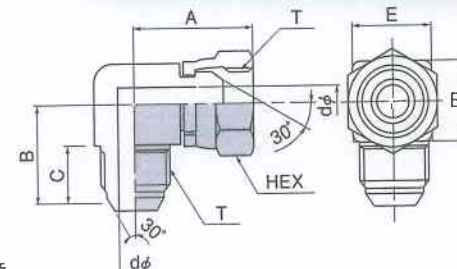

接続口金具：SR-02・SR-04

呼び径	ねじ T	Amm	Bmm	Cmm	dφmm	Emm	HEXmm
6	G <sup>1</sup> / <sub>4</sub>	27.0	24.0	16.0	5.5	16	19
9	G <sup>3</sup> / <sub>8</sub>	32.0	27.5	17.5	7.0	20	22
12	G <sup>1</sup> / <sub>2</sub>	36.0	32.0	20.0	10.0	24	27
19	G <sup>3</sup> / <sub>4</sub>	43.0	36.5	21.5	16.0	30	36
25	G 1	49.0	40.5	22.5	21.5	36	41
32	G1 <sup>1</sup> / <sub>4</sub>	60.5	49.5	27.0	27.5	45	50
38	G1 <sup>1</sup> / <sub>2</sub>	62.0	52.0	27.0	33.0	50	60
50	G 2	75.5	61.5	30.0	44.0	63	70

## SR-09R2 (2段階ち異径)



SUS は受注生産

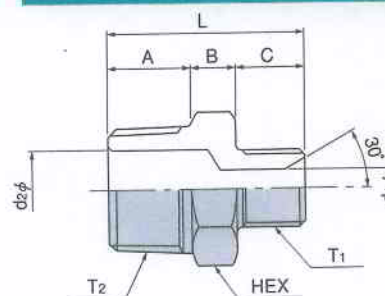

接続口金具：SR-05

YA1009 FUJI1009

呼び径	ねじ T <sub>1</sub>	ねじ T <sub>2</sub>	Amm	Bmm	Cmm	d <sub>1</sub> φmm	d <sub>2</sub> φmm	Lmm	HEXmm
3×9	G <sup>1</sup> / <sub>8</sub>	R <sup>3</sup> / <sub>8</sub>	11	8	15	4.0	7.0	34	19
6×12	G <sup>1</sup> / <sub>4</sub>	R <sup>1</sup> / <sub>2</sub>	13	8	18	5.5	10.0	39	22
9×19	G <sup>3</sup> / <sub>8</sub>	R <sup>3</sup> / <sub>4</sub>	15	12	20	7.0	16.0	47	27
12×25	G <sup>1</sup> / <sub>2</sub>	R 1	18	12	22	10.0	21.5	52	36